

RUSSELL GRAPHICS COPYRIGHT 2015

PROPERTY MAP OF

MAXIMUS MAPPER SEMPER

# MORGAN

VERMONT

TOWN OF MORGAN - ORLEANS COUNTY - VERMONT

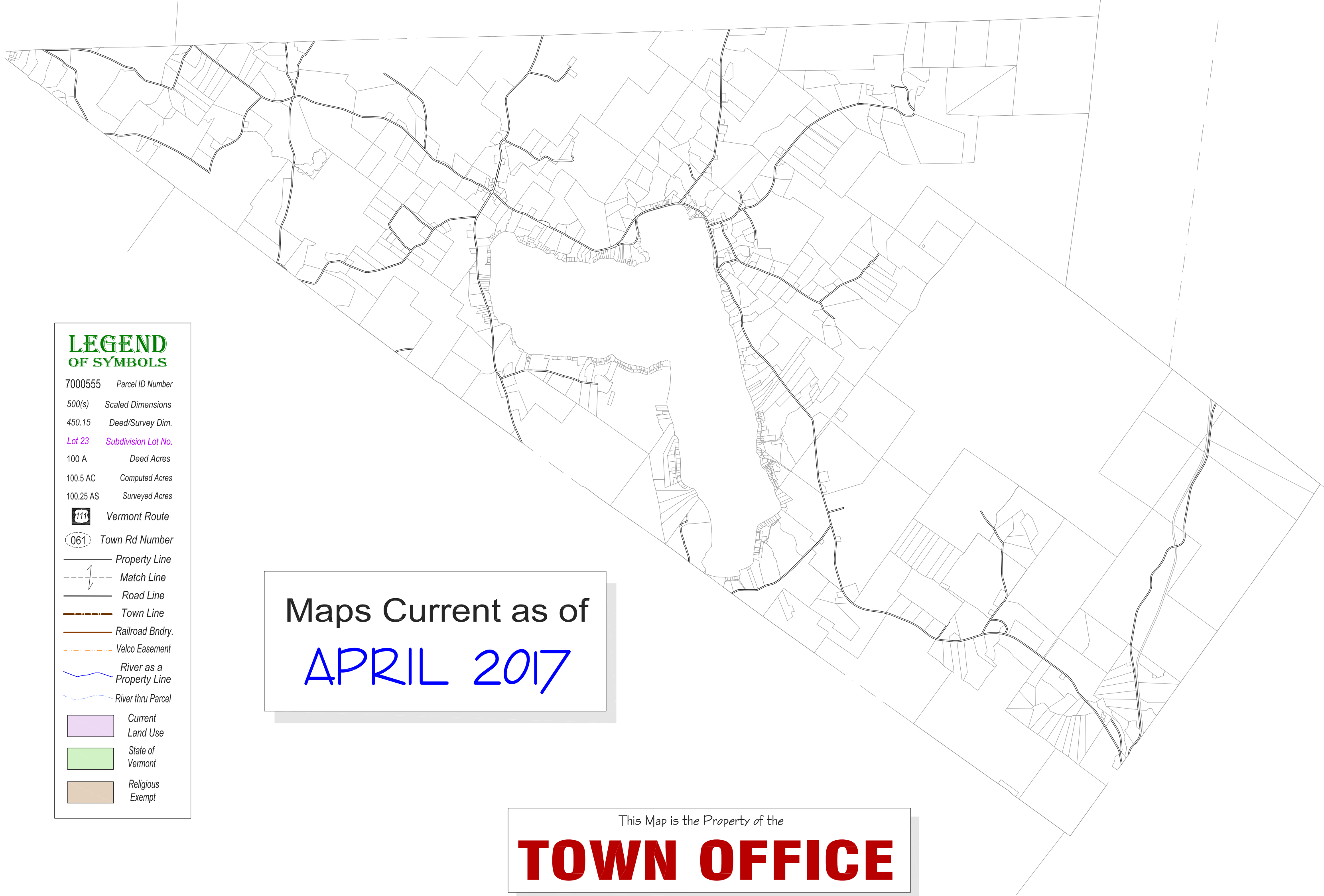

### LEGEND OF SYMBOLS

- 7000555 Parcel ID Number
- 500(s) Scaled Dimensions
- 450.15 Deed/Survey Dim.
- Lot 23 Subdivision Lot No.
- 100 A Deed Acres
- 100.5 AC Computed Acres
- 100.25 AS Surveyed Acres
- Vermont Route
- Town Rd Number
- Property Line
- Match Line
- Road Line
- Town Line
- Railroad Bndry.
- Velo Easement
- River as a Property Line
- River thru Parcel
- Current Land Use
- State of Vermont
- Religious Exempt

Maps Current as of

**APRIL 2017**

This Map is the Property of the

**TOWN OFFICE**

www.imapvt.com

Digital Mapping Prepared By

RUSSELL GRAPHICS

2207 Uregeton Ave.  
Raleigh, NC 27614  
802.309.8200

**T**his is Not a SURVEY and shall not be used for Description or Conveyance...

This Map was originally prepared by Russell Graphics in 2005, using Land Records recorded in the Town Clerk's Office. The current Parcel Map is updated annually by Russell Graphics. The accuracy of this map is determined by the filed information. All Data meets or exceeds specifications outlined in the Vermont Mapping Guidelines. This Map is the sole property of the Town and any copy, paper or digital, shall not be given without permission from the Town. ALL INFORMATION IS SUBJECT TO CHANGE.

PARCEL MAPS  
18" X 18" SIZE